

Harvester Handle Extension

ASSEMBLY AND INSTRUCTION MANUAL

This Kit Includes

			QTY
A	FF-1220	Handle Bar	1
B	FF-6189	Main Beam	1
C	FF-5124	Balance Handle	1
D	FF-9862	Throttle Handle Assembly	1
E	VP-8237	Washer	2
F	VP-7908	Handle Tube Screw	2
G	VP-8792	Handle Height Screw	1

			QTY
H	VP-7942	Mounting Screw	4
I	VP-5886	Height Adjustment Knob	1
J	VP-6734	Throttle Adjustment Knob	1

Tools Required:

- Drill or impact driver with a #2 Phillips bit
- 5/32" or 4mm hex key



Watch the assembly video!
Scan the code or visit: fmfr.io/hvrhndext/v



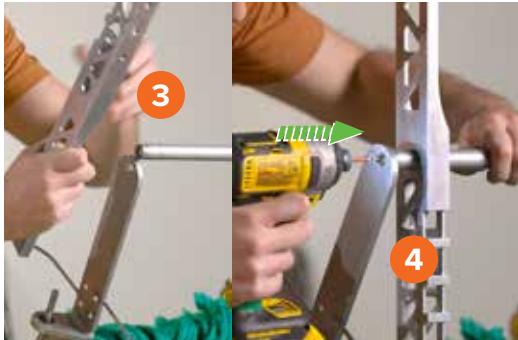
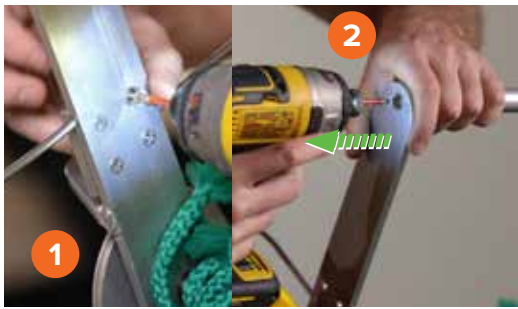

Assembly Instructions

1. Remove the four screws from the harvester's drill support plate ① and the handle screw ② at the top of the main upright.
2. Gently pry the harvester handle out of its recess and over the top of the upright ③. Slide the corresponding hole of the **Main Beam** onto the harvester handle, aligning the flat side of the main beam against the face of the harvester upright. Reinstall handle screw ④.
3. Reinstall the drill support plate with the **Main Beam** in place, using the four **Mounting Screws** ⑤ included in your hardware bag.
4. Hold the **Handlebar** horizontally with the 6 small adjustment holes to your right and the large handle hole on the left pointing out in front of you. Take the **Throttle Handle** and insert the end of the handle tube into the hole on the left of the handlebar, with the throttle trigger hanging down towards the ground ⑥. Mount the handle tube to the handlebar using a **Washer** and **Handle Tube Screw**, tightening with your hex key.
5. Mount the **Balance Handle** to the opposite end of the **Handlebar** in the same manner, so that the balance handle is facing in the opposite direction from the throttle handle ⑦.
6. Place the **Handlebar** in one of the height-adjustment notches of the **Main Beam** with the **Throttle Handle** oriented out away from and in front of the harvester ⑧. Align one of the Handlebar's side-adjustment holes with the corresponding hole in the back of the main beam. Attach the handlebar by inserting the **Handle Height Screw** into the corresponding hole in the back of the main beam, and thread the **Handle Height Knob** onto the end of the screw ⑨.

Note: Optimal handle height and side-adjustment position varies between different people and gardens. However, best side-to-side

balance is achieved by choosing the side-adjustment holes that shift the throttle handle as far out, away from the harvester, as possible, as your garden aisles allow. Adjustments can easily be made out in the field with no tools, so there's no need to sweat the choice of handle location right now.

7. Mount the drill to the driveshaft of the harvester with the drill battery oriented on the harvester-side of the drill support rod. Secure the drill chuck to the driveshaft **10** and the support strap to the battery.
8. Slide the throttle hose end into the end of the throttle trigger. Position the other end of the throttle hose in the groove of the **Main Beam** **11** with the cable end facing down. Thread the **Throttle Adjustment Knob** into the adjustment hole, leaving room for the hose to slip freely without falling out of the groove.
Note: Be sure to stand clear of the harvester blade from here on out, in case of accidental firing.
9. Buckle the drill strap around the drill trigger **12**.
10. Pull the throttle hose through the slot, adding a little tension to the drill strap without firing the drill trigger **13**. Tighten the **Throttle Adjustment Knob** to clamp the hose in place.
11. Grip the throttle trigger and test-fire the harvester **14**. If the harvester spins slower than preferred, loosen the **Throttle Adjustment Knob**, add more tension to the hose, and retry. If the harvester stays on after letting go of the throttle trigger, reduce the tension a little. When the harvester spins just as fast as when you manually press the drill trigger, then comes to a complete stop after releasing the throttle trigger, you've found the sweet spot.

★ Now your Handle Extension is all setup and ready to go. As you harvest, we encourage you to play around with different handle heights and positions to find what works best for you and your garden. **Happy Harvesting!**

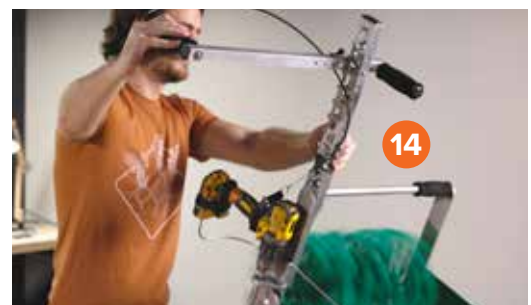
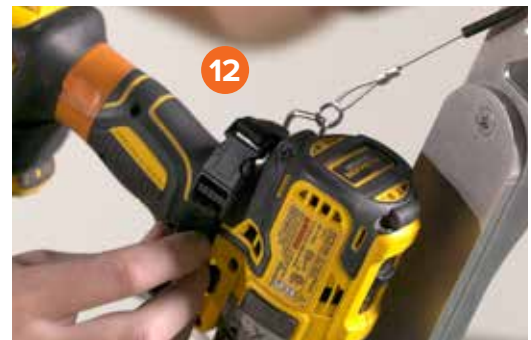



200 Good Life Way, Centerville, TN 37033 | support@farmersfriend.com | (931) 583-0397